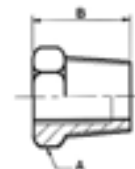

Réduction MF

Hexagonal bushing

Division basse pression
Low pressure division

2.

PN 100

| Acier - Steel A105N | | | | |
|---------------------|----------------|----|----|-------|
| Réf GAZ-BSP | DN | A | B | Kg |
| 103.1800 | 1/4" x 1/8" | 14 | 18 | 0.010 |
| 103.1801 | 3/8" x 1/8" | 19 | 19 | 0.026 |
| 103.1802 | 3/8" x 1/4" | 19 | 19 | 0.015 |
| 103.1803 | 1/2" x 1/8" | 21 | 23 | 0.050 |
| 103.1804 | 1/2" x 1/4" | 22 | 23 | 0.045 |
| 103.1805 | 1/2" x 3/8" | 22 | 23 | 0.025 |
| 103.1807 | 3/4" x 1/4" | 27 | 26 | 0.095 |
| 103.1808 | 3/4" x 3/8" | 27 | 26 | 0.075 |
| 103.1809 | 3/4" x 1/2" | 27 | 26 | 0.050 |
| 103.1811 | 1" x 1/4" | 35 | 30 | 0.175 |
| 103.1812 | 1" x 3/8" | 35 | 30 | 0.165 |
| 103.1813 | 1" x 1/2" | 35 | 30 | 0.135 |
| 103.1814 | 1" x 3/4" | 35 | 30 | 0.090 |
| 103.1818 | 1 1/4 x 1/2" | 46 | 33 | 0.325 |
| 103.1819 | 1 1/4 x 3/4" | 46 | 33 | 0.270 |
| 103.1820 | 1 1/4 x 1" | 46 | 33 | 0.195 |
| 103.1824 | 1 1/2 x 1/2" | 50 | 35 | 0.500 |
| 103.1825 | 1 1/2 x 3/4" | 50 | 35 | 0.420 |
| 103.1826 | 1 1/2 x 1" | 50 | 35 | 0.400 |
| 103.1827 | 1 1/2 x 1 1/4" | 50 | 35 | 0.200 |
| 103.1832 | 2" x 3/4" | 65 | 40 | 0.790 |
| 103.1833 | 2" x 1" | 65 | 40 | 0.720 |
| 103.1834 | 2" x 1 1/4" | 65 | 40 | 0.500 |
| 103.1835 | 2" x 1 1/2" | 65 | 40 | 0.400 |
| 103.1841 | 2 1/2 x 1" | 77 | 48 | 1.670 |
| 103.1842 | 2 1/2 x 1 1/4" | 77 | 48 | 1.250 |
| 103.1843 | 2 1/2 x 1 1/2" | 77 | 48 | 1.100 |
| 103.1844 | 2 1/2 x 2" | 77 | 48 | 0.750 |
| 103.1851 | 3" x 1 1/4" | 92 | 45 | 1.800 |
| 103.1852 | 3" x 1 1/2" | 92 | 52 | 1.920 |
| 103.1853 | 3" x 2" | 92 | 52 | 1.400 |
| 103.1854 | 3" x 2 1/2" | 92 | 52 | 1.800 |

PN 20

| Inox - Stainless steel 316 | | | | |
|----------------------------|----------------|----|----|-------|
| Réf GAZ-BSP | DN | A | B | Kg |
| 120.1800 | 1/4" x 1/8" | 14 | 15 | 0.010 |
| 120.1801 | 3/8" x 1/8" | 17 | 15 | 0.020 |
| 120.1802 | 3/8" x 1/4" | 17 | 15 | 0.015 |
| 120.1803 | 1/2" x 1/8" | 22 | 18 | 0.040 |
| 120.1804 | 1/2" x 1/4" | 22 | 18 | 0.030 |
| 120.1805 | 1/2" x 3/8" | 22 | 18 | 0.025 |
| 120.1807 | 3/4" x 1/4" | 27 | 22 | 0.055 |
| 120.1808 | 3/4" x 3/8" | 27 | 22 | 0.050 |
| 120.1809 | 3/4" x 1/2" | 27 | 22 | 0.050 |
| 120.1811 | 1" x 1/4" | 35 | 26 | 0.090 |
| 120.1812 | 1" x 3/8" | 35 | 26 | 0.100 |
| 120.1813 | 1" x 1/2" | 35 | 26 | 0.085 |
| 120.1814 | 1" x 3/4" | 35 | 26 | 0.075 |
| 120.1818 | 1 1/4 x 1/2" | 46 | 30 | 0.170 |
| 120.1819 | 1 1/4 x 3/4" | 46 | 30 | 0.155 |
| 120.1820 | 1 1/4 x 1" | 46 | 30 | 0.155 |
| 120.1825 | 1 1/2 x 3/4" | 50 | 30 | 0.200 |
| 120.1826 | 1 1/2 x 1" | 50 | 30 | 0.175 |
| 120.1827 | 1 1/2 x 1 1/4" | 50 | 52 | 0.125 |
| 120.1832 | 2" x 3/4" | 65 | 34 | 0.360 |
| 120.1833 | 2" x 1" | 65 | 34 | 0.330 |
| 120.1834 | 2" x 1 1/4" | 65 | 34 | 0.290 |
| 120.1835 | 2" x 1 1/2" | 65 | 34 | 0.245 |
| 120.1843 | 2 1/2 x 1 1/2" | 77 | 37 | 0.540 |
| 120.1844 | 2 1/2 x 2" | 77 | 40 | 0.485 |
| 120.1853 | 3" x 2" | 92 | 41 | 0.760 |
| 120.1854 | 3" x 2 1/2" | 92 | 41 | 0.500 |

Réduction FM

Negative bushing

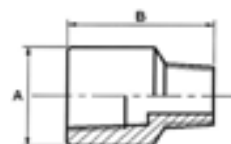

PN 100

| Acier - Steel A105N | | | | |
|---------------------|----------------|----|----|-------|
| Réf GAZ-BSP | DN | A | B | Kg |
| 103.2100 | 1/4" x 1/8" | 20 | 30 | 0.035 |
| 103.2101 | 3/8" x 1/8" | 25 | 32 | 0.065 |
| 103.2102 | 3/8" x 1/4" | 25 | 32 | 0.055 |
| 103.2103 | 1/2" x 1/8" | 30 | 38 | 0.145 |
| 103.2104 | 1/2" x 1/4" | 30 | 38 | 0.110 |
| 103.2105 | 1/2" x 3/8" | 30 | 39 | 0.105 |
| 103.2107 | 3/4" x 1/4" | 36 | 42 | 0.160 |
| 103.2108 | 3/4" x 3/8" | 36 | 43 | 0.165 |
| 103.2109 | 3/4" x 1/2" | 36 | 46 | 0.175 |
| 103.2112 | 1" x 3/8" | 50 | 45 | 0.380 |
| 103.2113 | 1" x 1/2" | 50 | 48 | 0.250 |
| 103.2114 | 1" x 3/4" | 50 | 50 | 0.260 |
| 103.2118 | 1 1/4 x 1/2" | 60 | 54 | 0.500 |
| 103.2119 | 1 1/4 x 3/4" | 60 | 36 | 0.480 |
| 103.2120 | 1 1/4 x 1" | 60 | 58 | 0.460 |
| 103.2125 | 1 1/2 x 3/4" | 70 | 58 | 0.880 |
| 103.2126 | 1 1/2 x 1" | 70 | 60 | 0.750 |
| 103.2127 | 1 1/2 x 1 1/4" | 70 | 63 | 0.800 |
| 103.2133 | 2" x 1" | 80 | 60 | 0.950 |
| 103.2134 | 2" x 1 1/4" | 80 | 65 | 1.100 |
| 103.2135 | 2" x 1 1/2" | 80 | 66 | 1.020 |
| 103.2143 | 2 1/2 x 1 1/2" | 95 | 80 | 1.210 |
| 103.2144 | 2 1/2 x 2" | 95 | 80 | 1.210 |

PN 20

| Inox - Stainless steel 316 | | | | |
|----------------------------|----------------|----|----|-------|
| Réf GAZ-BSP | DN | A | B | Kg |
| 120.2100 | 1/4" x 1/8" | 17 | 21 | 0.015 |
| 120.2102 | 3/8" x 1/4" | 22 | 25 | 0.030 |
| 120.2104 | 1/2" x 1/4" | 24 | 29 | 0.035 |
| 120.2105 | 1/2" x 3/8" | 24 | 29 | 0.040 |
| 120.2108 | 3/4" x 3/8" | 30 | 32 | 0.060 |
| 120.2109 | 3/4" x 1/2" | 30 | 34 | 0.065 |
| 120.2113 | 1" x 1/2" | 42 | 39 | 0.130 |
| 120.2114 | 1" x 3/4" | 42 | 40 | 0.120 |
| 120.2119 | 1 1/4 x 3/4" | 50 | 44 | 0.210 |
| 120.2120 | 1 1/4 x 1" | 50 | 45 | 0.225 |
| 120.2126 | 1 1/2 x 1" | 55 | 47 | 0.255 |
| 120.2127 | 1 1/2 x 1 1/4" | 55 | 47 | 0.280 |
| 120.2134 | 2" x 1 1/4" | 65 | 52 | 0.340 |
| 120.2135 | 2" x 1 1/2" | 65 | 52 | 0.384 |

Réduction hexagonal pour les références 120.2100 à 120.2109.
 Réduction circulaire pour les références 120.2113 jusqu'au 120.2135
 Hexagonal negative bushing from ref 120.2100 to 120.2109.
 Negative circular bushing from ref 120.2113 to 120.2135.

Réduction circulaire pour les références 103.2100 à 103.2144

Negative circular bushing from 103.2100 to 103.2144

Toutes informations techniques et illustrations sont données à titre indicatif et sans aucun caractère contractuel - All technical informations and illustrations are provided for information purposes only and are not contractually binding.