



## MoyaStop PVC

PVC Waterstops

**DESCRIPTION** **MoyaStop PVC** is a pre formed watertop made by high grade poly vinyl chloride resin extrusion compound that is plasticised and stabilized to offer long term performance, resistance to abrasion and attack by waterborne chemicals, alkalis and hydrocarbons. **MoyaStop PVC** is available in different profiles for placement either centrally and externally.

**USES** **MoyaStop PVC** waterstop provides sealing of construction and expansion joints in various concrete structures.

**ADVANTAGES**

- Different profiles to suit site requirements
- Provides tortuous path
- Excellent flexibility and longevity
- Can be easily joined on site

### TYPICAL PROPERTIES

PROPERTY	TEST METHOD	VALUE
Shore A Hardness	ASTM D2240	79 +_ 3
Water Absorption	ASTM D570	0.02
Tensile Strength	ASTM D 638	13.8 N/mm <sup>2</sup>
Density	ASTM D 792	1.34 +_ 0.02 g/cm <sup>3</sup>
Ultimate Elongation	ASTM D 638	360%
Low temperature brittleness	ASTM D 746	Passed at -35°C

### PROFILES

#### MoyaStop PVC - Type A Centrally Placed

Central bulb sections are used in expansion, construction and contraction joints. The bulb allows for movement in the joints.

#### MoyaStop PVC - Type B Centrally Placed

Type B sections without the centre bulb are used in construction and contraction joints.

#### MoyaStop PVC - Type C Externally Placed

This profile of the waterstop is placed along with the shutter on construction joints for external placement.

#### MoyaStop PVC - Type D Externally Placed

Type D profiles can be placed along with the shutter in expansion joints. Centre box allows for movement in the joints.





## MoyaStop PVC

### APPLICATION

#### MoyaStop PVC - Type A Centrally Placed

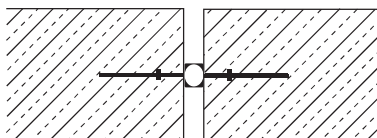

#### MoyaStop PVC - Type B Centrally Placed

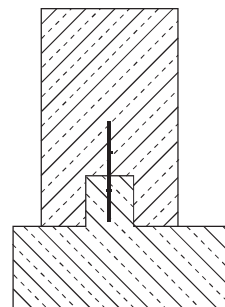

#### MoyaStop PVC - Type C Externally Placed

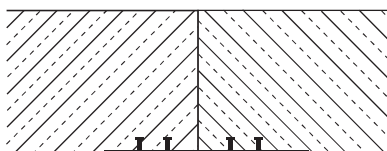

#### MoyaStop PVC - Type D Externally Placed

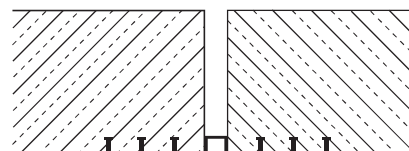

Waterstops can be joined together with the help of heater blades and jointing jigs. Waterstops should be kept in their correct positions before placement of concrete. Care should be taken to compact the concrete all around the waterstop while ensuring that waterstops are not displaced or wrapped during concreting.

### RANGE

<b>MoyaStop PVC - Type A</b>	150 mm, 200 mm, 250 mm, 300 mm width
<b>MoyaStop PVC - Type B</b>	150 mm, 200 mm, 250 mm, 300 mm width
<b>MoyaStop PVC - Type C</b>	200 mm, 250 mm, 300 mm width
<b>MoyaStop PVC - Type D</b>	200 mm, 240 mm, 300 mm width
Other profiles are available on request.	

### NOTE

Customers are advised to confirm pack size and availability at the time of order.

### GENERAL INFORMATION

#### Storage

Store in a cool and shaded area protected from UV and high temperatures. Prolonged exposure to sunlight and harsh environment will result in deterioration of the product. Keep away from sharp edges to prevent damage.

### HEALTH and SAFETY

#### PPE's

#### Precautions

Gloves, goggles and organic vapour mask must be worn. Provide ventilation while hot welding of PVC water stops as it may cause respiratory irritation.

#### Hazard

It is regarded as non hazardous for transportation.

#### Disposal

To be disposed off as per local rules and regulations.

#### Additional Information

Refer MSDS for detailed information.



## MoyaStop PVC

### TECHNICAL SERVICE

**CONMIX Technical Services** are available on request for onsite support to assist in the correct use of its products.

Manufacturer:

**CONMIX LTD.**

P.O. Box 5936, Sharjah

United Arab Emirates

Tel: +971 6 5314155

Fax: +971 6 5314332

Email: [conmix@conmix.com](mailto:conmix@conmix.com)

Sales Office:

Tel: +971 6 5682422

Fax: +971 6 5681442

[www.conmix.com](http://www.conmix.com)



It is the customer's responsibility to satisfy themselves by checking with the company whether information is still current at the time of use. The customer must be satisfied that the product is suitable for the use intended. All products comply with the properties shown on current data sheets. However, Conmix does not warrant or guarantee the installation of the products as it does not have any control over installation or end use of the product. All information and particularly the recommendations relating to application and end use are given in good faith. The products are guaranteed against any manufacturing defects and are sold subject to Conmix standard terms and conditions of sale.