



121-08/121-36

1/2" Sockets hexagonal mm



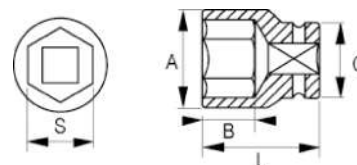

DÉTAILS SUR LE PRODUIT

- Douille 1/2", 6 pans, dimensions en mm
- Alliage d'acier au chrome vanadium
- Finition chromée et brillante
- Profil NPP
- Normes : DIN3120, DIN3124



ATTRIBUTS DU PRODUIT

Produit		A	B	C	L	
121-08	8 mm	14.8 mm	13 mm	22 mm	38 mm	50 g
121-09	9 mm	15.3 mm	13 mm	22 mm	38 mm	48 g
121-10	10 mm	15.3 mm	13 mm	22 mm	38 mm	49 g
121-11	11 mm	16.5 mm	13 mm	22 mm	38 mm	50 g
121-12	12 mm	17.8 mm	13 mm	22 mm	38 mm	52 g
121-13	13 mm	19 mm	13 mm	22 mm	38 mm	54 g
121-14	14 mm	20.3 mm	13 mm	22 mm	38 mm	56 g
121-15	15 mm	22 mm	17.8 mm	20.5 mm	38 mm	57 g
121-16	16 mm	22 mm	17.8 mm	20.5 mm	38 mm	71 g
121-17	17 mm	24 mm	17.8 mm	21.9 mm	38 mm	72 g
121-18	18 mm	25 mm	17.8 mm	22.9 mm	38 mm	90 g
121-19	19 mm	26 mm	17.8 mm	22.9 mm	38 mm	84 g
121-20	20 mm	28 mm	17.8 mm	23.9 mm	38 mm	87 g
121-21	21 mm	28 mm	17.8 mm	23.9 mm	38 mm	95 g
121-22	22 mm	30 mm	17.8 mm	26.1 mm	38 mm	97 g
121-23	23 mm	32 mm	17.8 mm	28.1 mm	38 mm	103 g
121-24	24 mm	32 mm	17.8 mm	28.1 mm	38 mm	109 g
121-25	25 mm	34 mm	17.8 mm	29.1 mm	40 mm	146 g
121-26	26 mm	34 mm	17.8 mm	29.1 mm	42 mm	192 g
121-27	27 mm	36 mm	17.8 mm	30.1 mm	42 mm	211 g
121-28	28 mm	38 mm	17.8 mm	32.1 mm	42 mm	212 g
121-30	30 mm	40 mm	17.8 mm	34.1 mm	44 mm	214 g
121-32	32 mm	42 mm	17.8 mm	36.1 mm	44 mm	217 g
121-34	34 mm	50 mm	18 mm	38 mm	44 mm	260 g
121-36	36 mm	52 mm	18.2 mm	40 mm	45 mm	300 g