



MARTIN® SQC2™

Secondary Belt Cleaner

The **MARTIN® SQC2™ Secondary Belt Cleaner** incorporates individually-cushioned tungsten carbide blades for effective cleaning without risk to belt, splice, or blade. Installed in the secondary cleaner position, the MARTIN® SQC2™ Cleaner's blade buffers cushion impact and maintains cleaning pressure.



BENEFITS

- Cushioned Blades Maintain Efficiency**
 Patented rubber buffers maintain cleaning pressure while deflecting to allow splices to pass.
- Built for Tough Conditions**
 Rugged construction withstands punishing applications, like high-speed belts and high-tonnage loads.
- Easy Cartridge Removal**
 The procedure is simple: remove pin, slide out cartridge, service, and return.
- Easy Adjustment of Cleaning Pressure**
 MARTIN® SQC2™ Tensioner allows simple alteration of blade-to-belt pressure to maintain cleaning efficiency regardless of blade wear. Lock pin keeps tensioner in place to maintain constant tension.
- Fits in Tight Spaces**
 Compact design allows installation in close quarters; narrow profile resists material buildup.
- Blades to Match Application**
 Specify tungsten carbide tips for normal, acidic, or high-impact conditions. Blades conform to belt profile by adjusting individually to provide continuous contact across the belt.
- Handles Reversing Belts and Belt Rollback**
 Rubber buffers allow for reversal of belt direction without damage to belt.

NOMENCLATURE

SQC2-XX X XX XX X X X

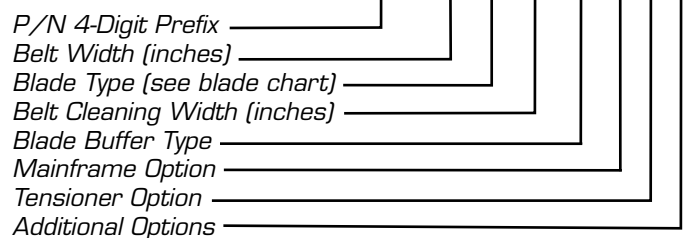

BLADE TYPE

- C:**
- D:**
- G:** See Blade Chart
- H:** for details
- R:**
- T:**
- U:**
- Ø:** No Blades

BLADE CLEANING WIDTH

Full belt width or Approx. 6 inches less belt width.

BLADE BUFFER TYPE/ URETHANE COLOR

- MR:** Molded Rubber
- FR:** Flame-Retardant Rubber
- ØØ:** No Buffers
- Ø3:** Orange Urethane
- B3:** Brown Urethane
- G3:** Green Urethane

MAINFRAME OPTIONS

- P:** Orange
- S:** Stainless Mainframe

TENSIONER OPTIONS

- T:** Tensioner included
- Ø:** No Tensioner
- S:** 316 SS

ADDITIONAL OPTIONS

- Ø:** None
- D:** Dust-Tight Steel Cover Door

DIMENSIONS

Belt Width	DIM "A" in. (mm)	DIM "B" in. (mm)	# of MARTIN® SQC2™ Blades	# of MARTIN® SAF-2™ Blades
18 (450)	48.94 (1243)	11.81 (300)	2	6
24 (600)	54.85 (1393)	17.72 (450)	3	8
30 (750)	60.75 (1543)	23.62 (600)	4	10
36 (900)	66.66 (1693)	29.53 (750)	5	12
42 (1050)	72.56 (1843)	35.43 (900)	6	14
48 (1200)	78.47 (1993)	41.34 (1050)	7	16
54 (1350)	84.37 (2143)	47.24 (1200)	8	18
60 (1500)	90.28 (2293)	53.15 (1350)	9	20
66 (1650)	96.19 (2443)	59.06 (1500)	10	22
72 (1800)	102.09 (2593)	64.96 (1650)	11	24
78 (1950)	108.00 (2743)	70.87 (1800)	11	26
84 (2100)	114.90 (2893)	76.77 (1950)	12	28
90 (2250)	119.81 (3043)	82.68 (2100)	13	30
96 (2400)	125.71 (3193)	88.58 (2250)	14	32

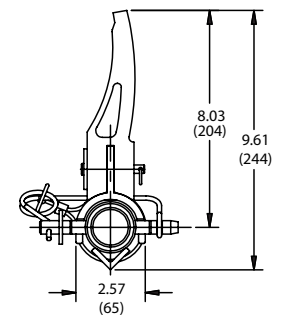
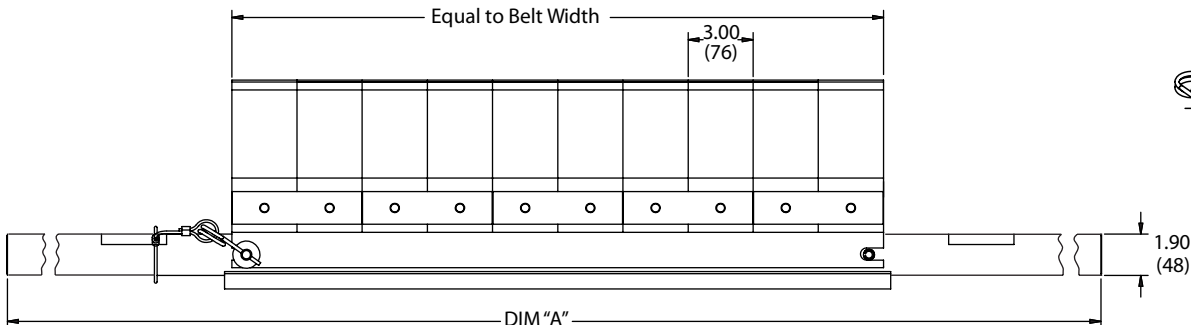
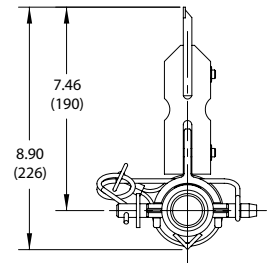
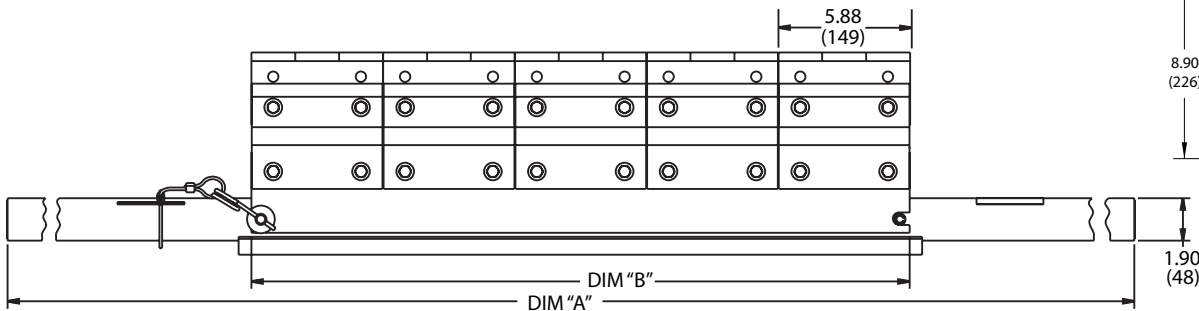

APPLICATION NOTES

Martin Engineering recommends that the MARTIN® SQC2™ Secondary Belt Cleaner System be installed so the cleaning blade contacts the belt at a point 2 to 4 in. (51 to 102 mm) after the point where the belt leaves the head (discharge) pulley. If obstructions prevent installation at this point, or if additional cleaners are desired, the cleaner should be installed 2 to 4 in. (51 to 102 mm) past the point where the belt leaves the support idler.

See your Martin Engineering representative for more information, or visit www.martin-eng.com.

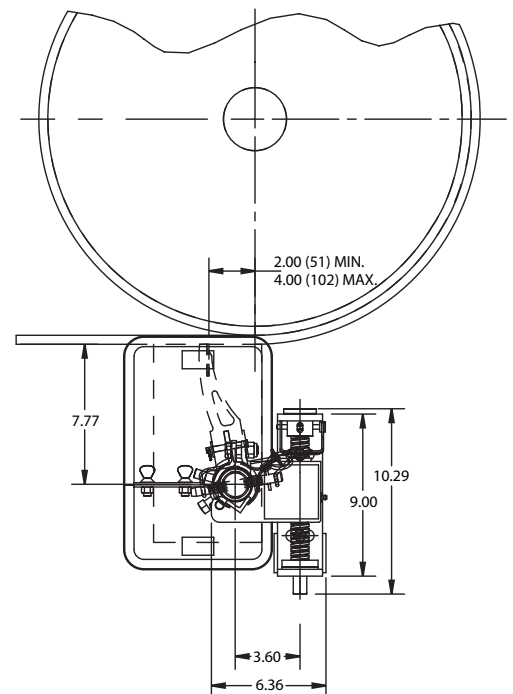
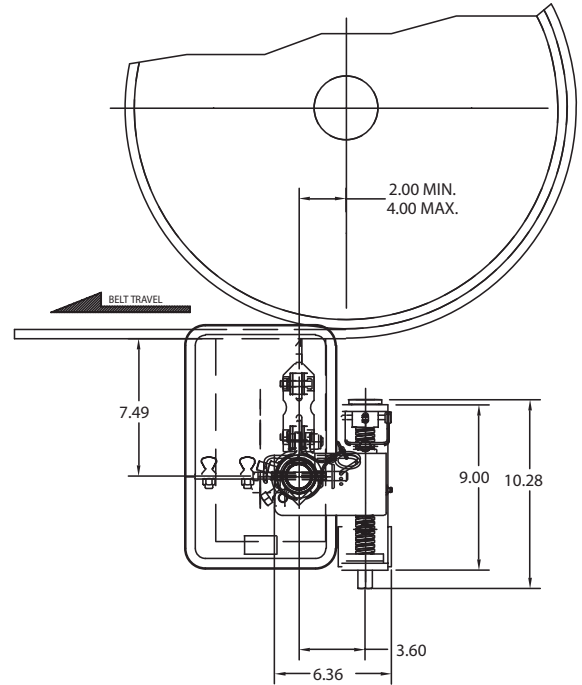
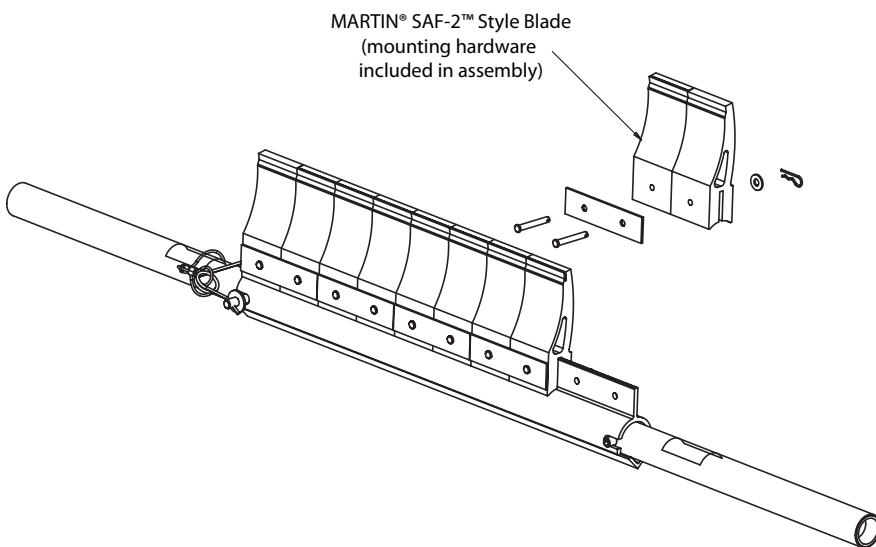
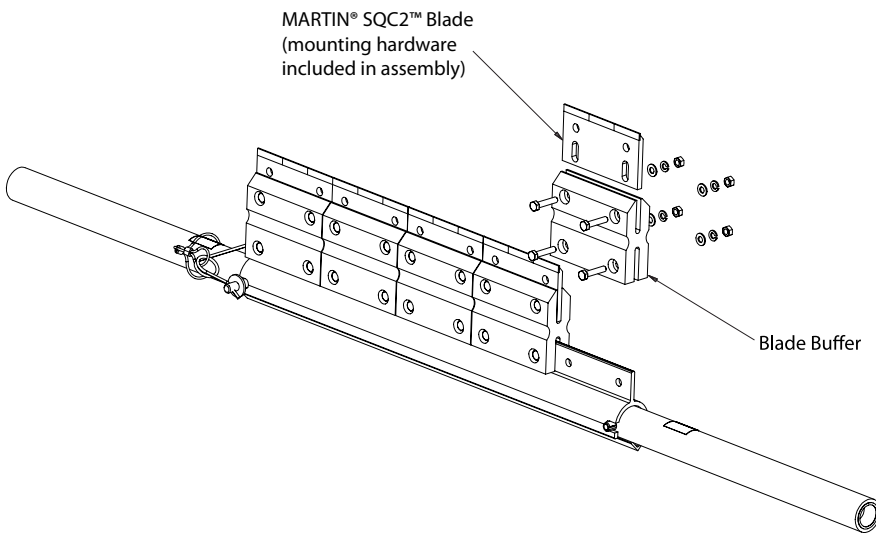

MARTIN® SQC2™ BLADES

COLOR	GENERAL APPLICATION	Replacement Blade P/N	
		Martin Engineering	Scorpio Conveyor Products
White	General Conditions: TC Blade for mechanical splices	SC-10002-C	745 SAND 150
White	General Conditions: TC Blade	SC-10002-D	N/A
Orange	Acid-Resistant: TC Blade for mechanical splices	SC-10002-G	745 S/ACID 150
Orange	Acid-Resistant: TC Blade	SC-10002-H	N/A
Orange	Reversing Belts	SC-10002-R	N/A

MARTIN® SAF-2™ STYLE 3 INCH WIDE BLADES

COLOR	GENERAL APPLICATION	Replacement Blade P/N
Orange	General Applications: TC Blade	38231-T
Orange	General Applications: Urethane Blade	38231-U
Brown	Acid-Resistant: TC Blade	38231-TBR
Brown	Acid-Resistant: Urethane Blade	38231-UBR
Green	Hi Temperature: TC Blade 300°F continuous 350°F intermittent	38231-TGR
Green	Hi Temperature: Urethane Blade 300°F continuous 350°F intermittent	38231-UGR

For other applications, please contact your Martin Engineering representative.
TC = Tungsten

ACCESSORIES

PART	P/N
MARTIN® SQC2™ Split-Cover Door	38014-SQC
MARTIN® Hanger Mount Heavy-Duty Assembly	34233-HD

SQC2 INSPECTION DOORS

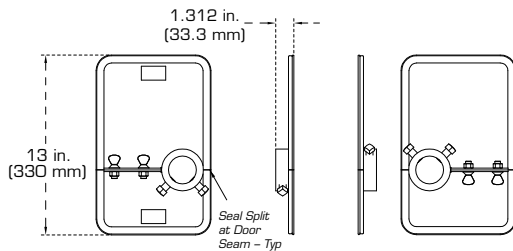

HANGER MOUNT

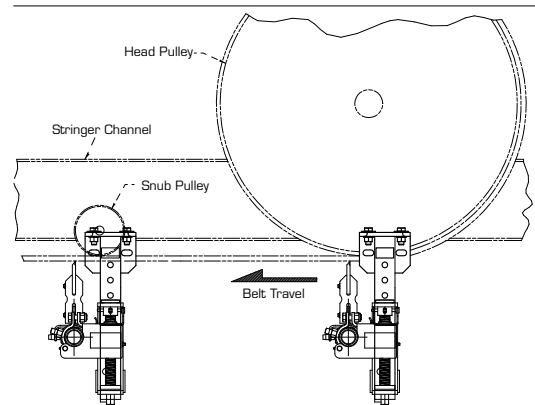

Patents and patents pending, © Registered trademark of Martin Engineering Company in the U.S. and other select locations. Additional information can be obtained at www.martin-eng.com/trademarks.

**QUALITY MANAGEMENT SYSTEM
CERTIFIED BY DNV
ISO 9001**

MARTIN ENGINEERING USA
One Martin Place
Neponset, IL 61345-9766 USA
800-544-2947 or 309-594-2384
FAX: 309-594-2432
www.martin-eng.com